

SETTING OUT DATA FLUSH KERBS

POINT	EASTING	NORTHING
1	55237.80	147044.90
2	55245.90	147040.25
3	55269.60	147085.26
4	55276.30	147080.90

APPROX. POSITIONS. LOCATE AGAINST EXISTING EDGE OF SPOON DRAIN.

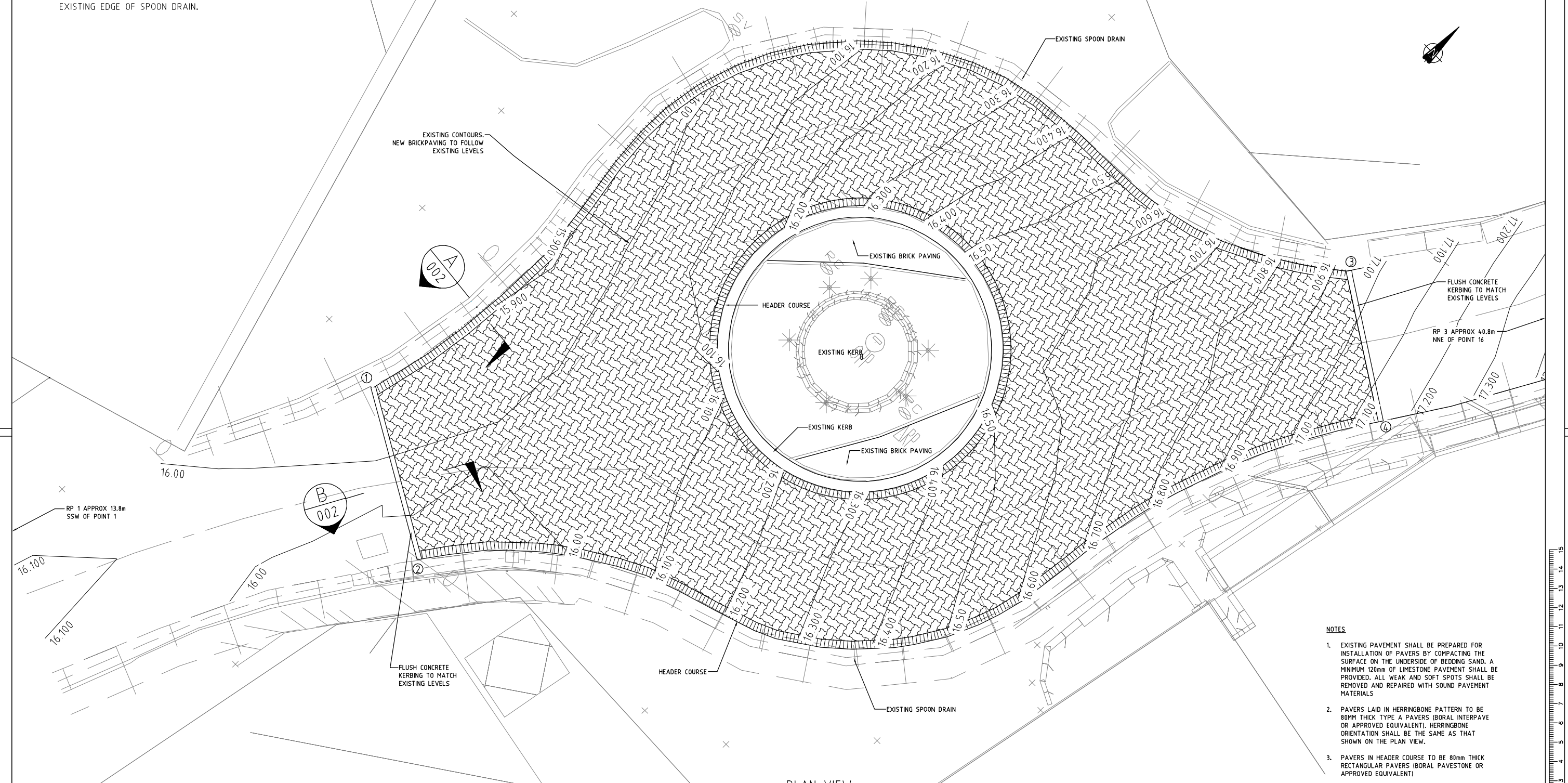

- NOTES**
- EXISTING PAVEMENT SHALL BE PREPARED FOR INSTALLATION OF PAVERS BY COMPACTING THE SURFACE ON THE UNDERSIDE OF BEDDING SAND. A MINIMUM 120mm OF LIMESTONE PAVEMENT SHALL BE PROVIDED. ALL WEAK AND SOFT SPOTS SHALL BE REMOVED AND REPAIRED WITH SOUND PAVEMENT MATERIALS
 - PAVERS LAID IN HERRINGBONE PATTERN TO BE 80MM THICK TYPE A PAVERS (BORAL INTERPAVE OR APPROVED EQUIVALENT). HERRINGBONE ORIENTATION SHALL BE THE SAME AS THAT SHOWN ON THE PLAN VIEW.
 - PAVERS IN HEADER COURSE TO BE 80mm THICK RECTANGULAR PAVERS (BORAL PAVESTONE OR APPROVED EQUIVALENT)
 - PAVERS TO BE LAID AT EVEN GRADE BETWEEN EXISTING EDGES AND CONTOUR LEVELS GIVEN ON PLAN.
 - PAVING QUANTITIES:
HEADER COURSE - 155m²
HERRINGBONE PATTERN - 830m²

SURVEY STATION POINTS			
POINT	EASTING	NORTHING	LEVEL
RP 1	55225.125	147025.146	15.94
RP 2	55259.021	147062.615	16.47
RP 3	55292.823	147117.958	18.45

WML CONSULTANTS
CONSULTING CIVIL, GEOTECHNICAL & STRUCTURAL ENGINEERS
PROJECT MANAGERS
FIRST FLOOR, 62 WITTENOOM STREET BUNBURY, WA 6230
POST OFFICE BOX 2023, BUNBURY WA 6231
TELEPHONE: (08) 9722 3544 FAX: (08) 9722 3599

REVISIONS				
N°	DESCRIPTION	CHECKED	DATE	DRAWN
B	PAVER ORIENTATION NOTES CHANGED	G. WOODROOF	04/2008	GC
A	ISSUE FOR TENDER	G. WOODROOF	03/2008	GC

NAMES PRINTED IN FULL		DATE	CLIENT
DESIGNED	G. WOODROOF	JAN '08	SHIRE OF CHRISTMAS ISLAND
DRAWN	G. CLARKE	JAN '08	
CHECKED	G. WOODROOF	MAR '08	PROJECT
APPROVED	G. WOODROOF	25/4/08	JALAN PANTAI ROUNABOUT

DRAWING TITLE	
JALAN PANTAI ROUNDABOUT PAVING PLAN	
SEGMENTAL PAVING OPTION	

THIS DRAWING SHALL BE TREATED AS PRELIMINARY AND IS NOT TO BE USED FOR CONSTRUCTION PURPOSES UNLESS SIGNED AS APPROVED.

DRAWING NUMBER: **3444-C-100 B**

REVISION

